



8 Warren Court  
Hampton Hargate PE7 8HA  
Offers in the region of £130,000

2 1 1 C

## 8 Warren Court Hampton Hargate PE7 8HA

Well presented & proportioned first floor apartment on Warren Court, a popular part of Hampton Hargate.

This property comprises of;

Lounge/diner with Juliet balcony, storage cupboard and open to the fitted kitchen. Two double bedrooms and a bathroom. Allocated parking

This property benefits from very well kept communal areas, Intercom entry system and an ideal central location within Hampton Hargate being close to local amenities and major transport links. This property is offered with No Forwarding Chain.

Tenure: Leasehold  
Service Charge: £1,175 P/A  
Ground Rent: £150.00 P/A  
Council Tax Band: B





Lounge/Diner  
18'1" max x 12'4" (5.52m max x 3.76m)

Kitchen  
9'1" x 6'8" (2.77m x 2.05m)

Bedroom One  
14'0" x 8'10" (4.27m x 2.70m)

Bedroom Two  
10'2" x 8'7" (3.10m x 2.64m)



Bathroom



## Floor Plan

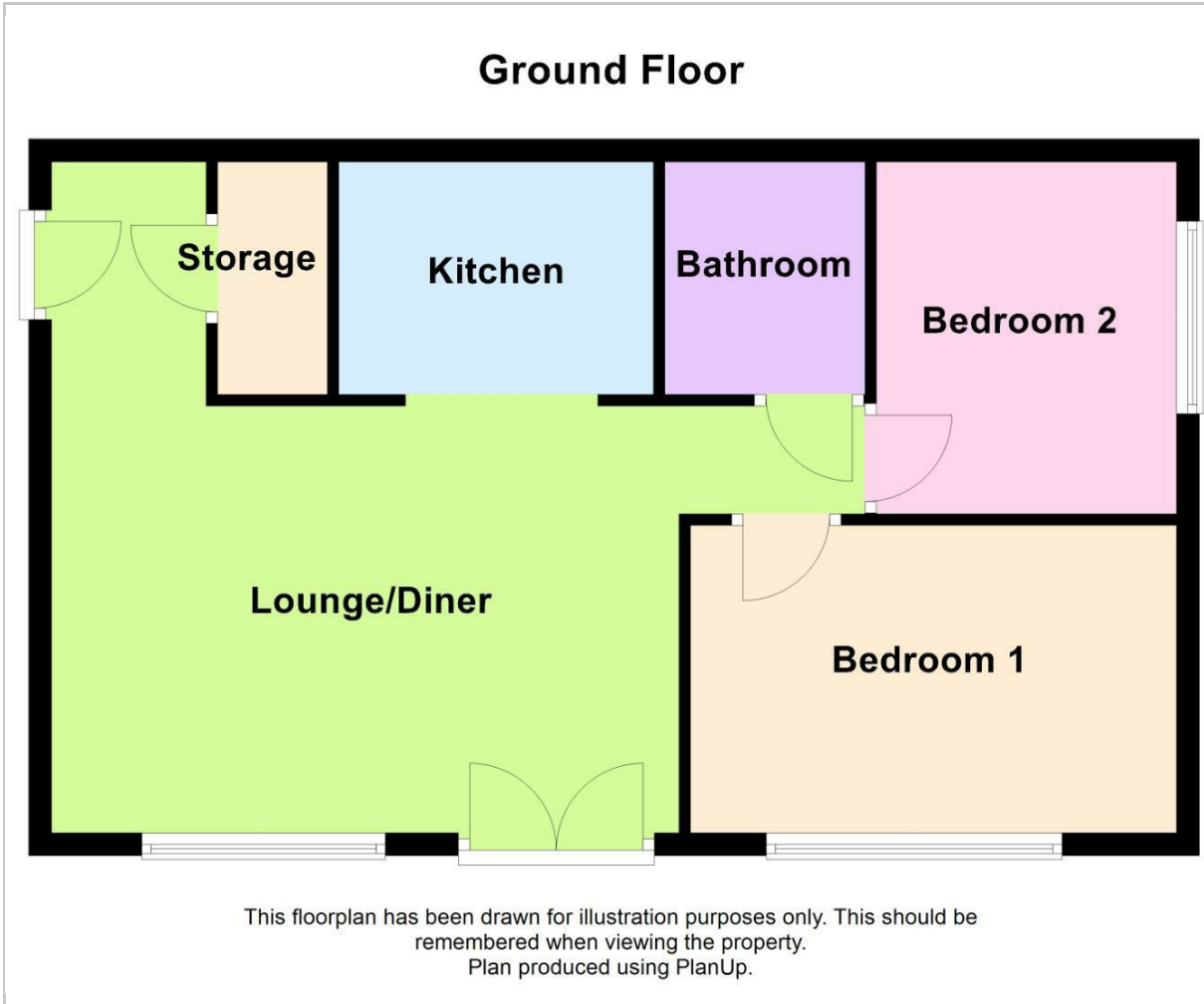

## Viewing

Please contact our Orton Office on 01733 852257 if you wish to arrange a viewing appointment for this property or require further information.

These particulars, whilst believed to be accurate are set out as a general outline only for guidance and do not constitute any part of an offer or contract. Intending purchasers should not rely on them as statements of representation of fact, but must satisfy themselves by inspection or otherwise as to their accuracy. No person in this firm's employment has the authority to make or give any representation or warranty in respect of the property.



48b Church Drive, Orton Waterville  
Peterborough, PE2 5HE  
T: 01733 852257  
E: orton@firminandco.co.uk

## Area Map

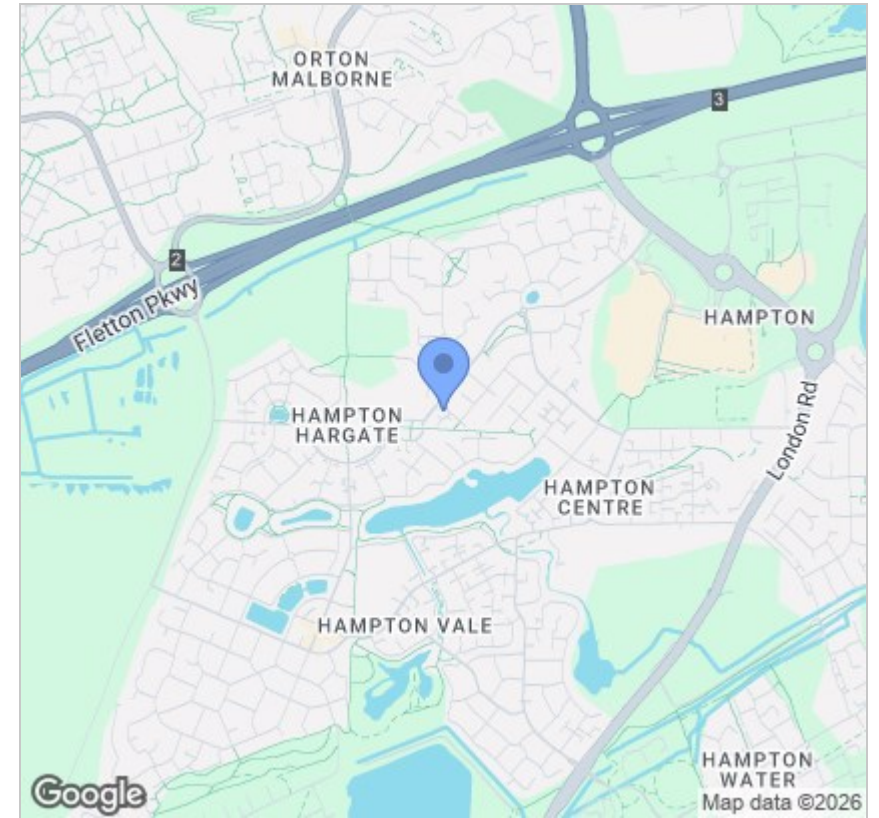

## Energy Efficiency Graph

